

Easy Template Path Hints for M2

(Magento 2.x)

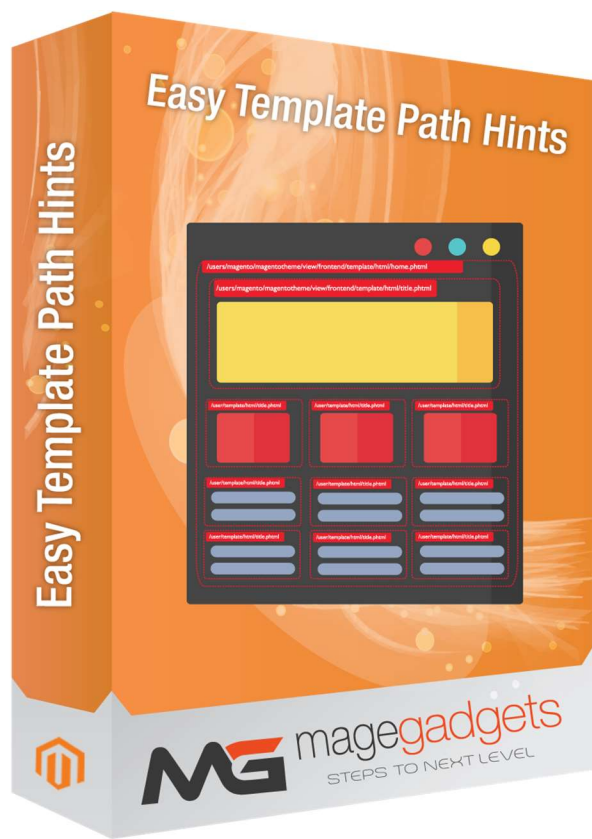

Magento Extension User Guide

Official extension page: [Easy Template Path Hints - MageGadgets Extensions](#)

2. All settings are available admin:

Go to Admin -> Store -> Setting -> Configuration > magegadgets> easytemplate path hints

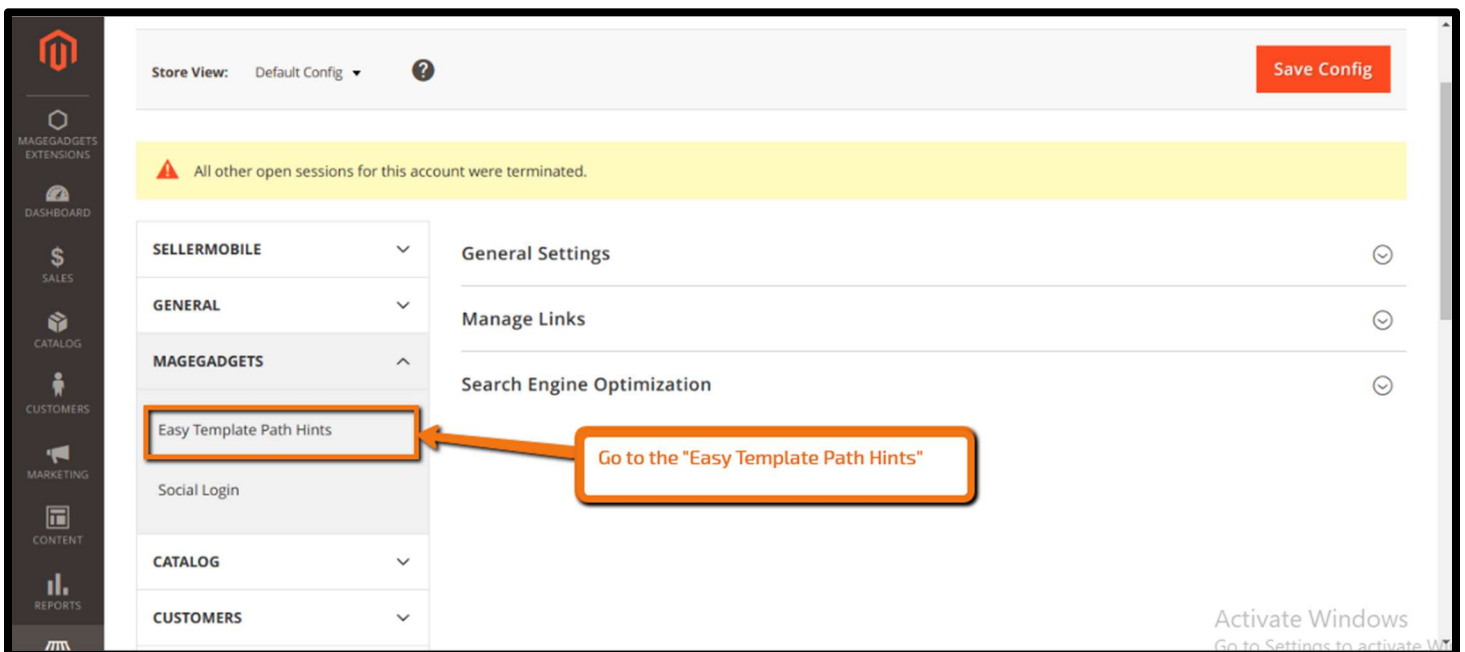
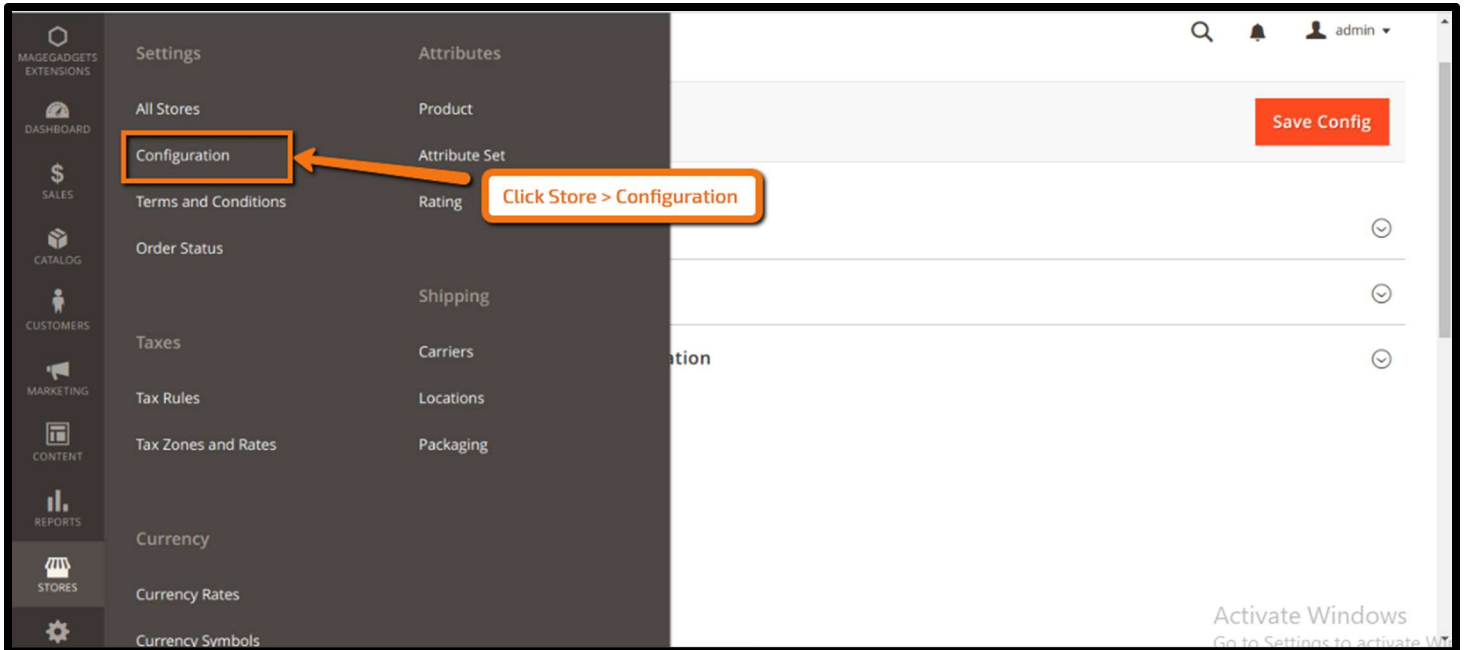

3. Installation / Configuration:

1) Just copy & paste the 'app' folder provided in the extension zip file to the root of your magento installation.

2) After installation go to Admin:

System >> Configuration >> Magegadgets Extensions >> Easy Template Path Hints >> Manage your setting here..

Example:

General Settings

Enabled=Yes

Access Code=Enter you code here which will be used for enabling the template path hints

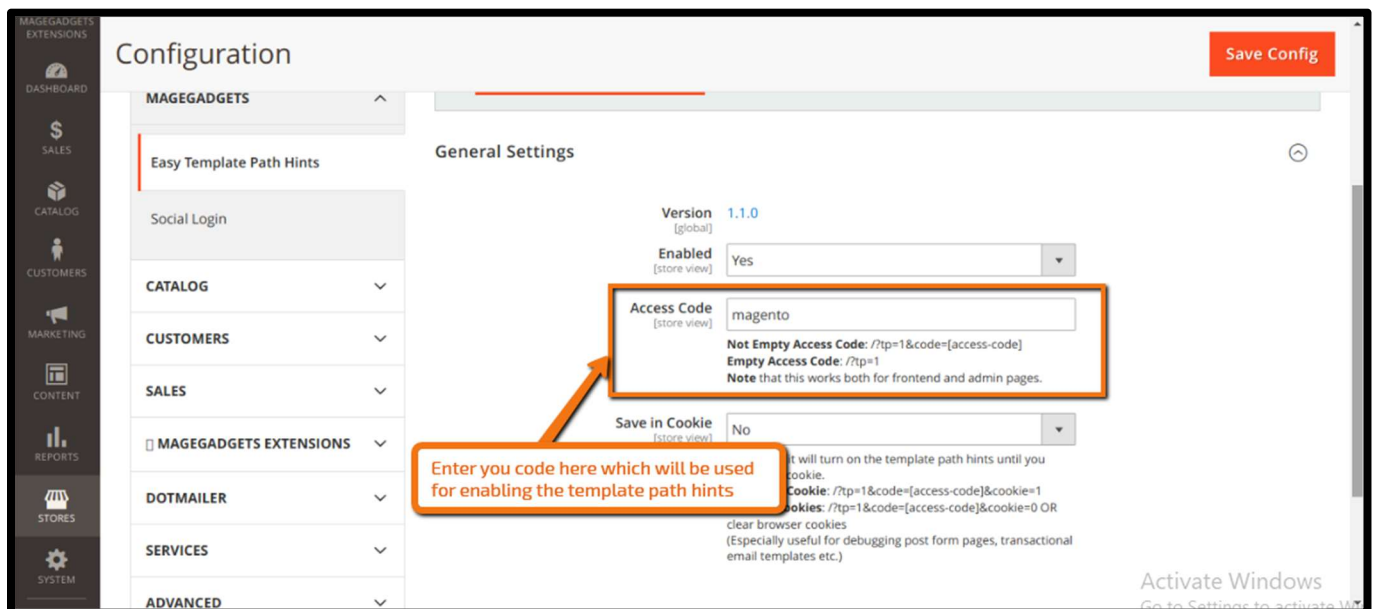

4. Make it quick!

- * Direct template path hints for all pages
- * It works for both Frontend **as well as** Backend.
- * This feature gives you the power to turn on/off the template path hints on the fly without going back and forth with System > Developer Settings.

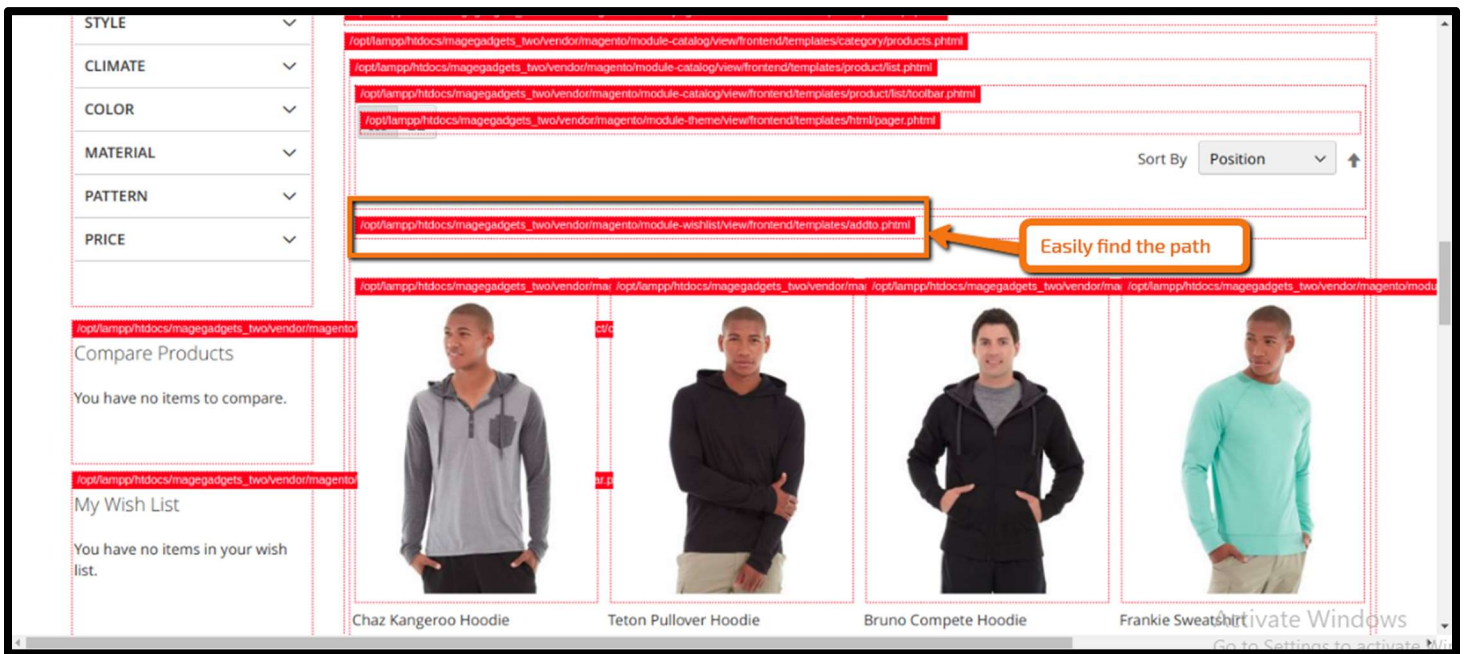

Please also note the settings comments which are quite explanatory.

Notes:

- 1) Disable the Cache before Installation or Refresh the Cache after Installation.
- 2) Disable the Compilation (System > Tools > Compilation)
- 3) If you get 'Access Denied' error in System > Configuration, then try to logout & re-login.
- 4) Visit official site for more info: <http://www.magegadgets.com/easy-template-path-hints.html>

Usage:

Just add query string: ?tp=1&code=code-that-you-configured-in-backend to any url of backend or frontend.

For example:

Frontend: <http://magento-url/apparel/shirts/zolof-the-rock-and-roll-destroyer-lol-cat-t-shirt.html?tp=1&code=magento>

Backend: http://magento-url/admin/admin/catalog_product/index/key/be8877b200d0bf2a8a32dc21e42eb0e5/?tp=1&code=magento

Result:

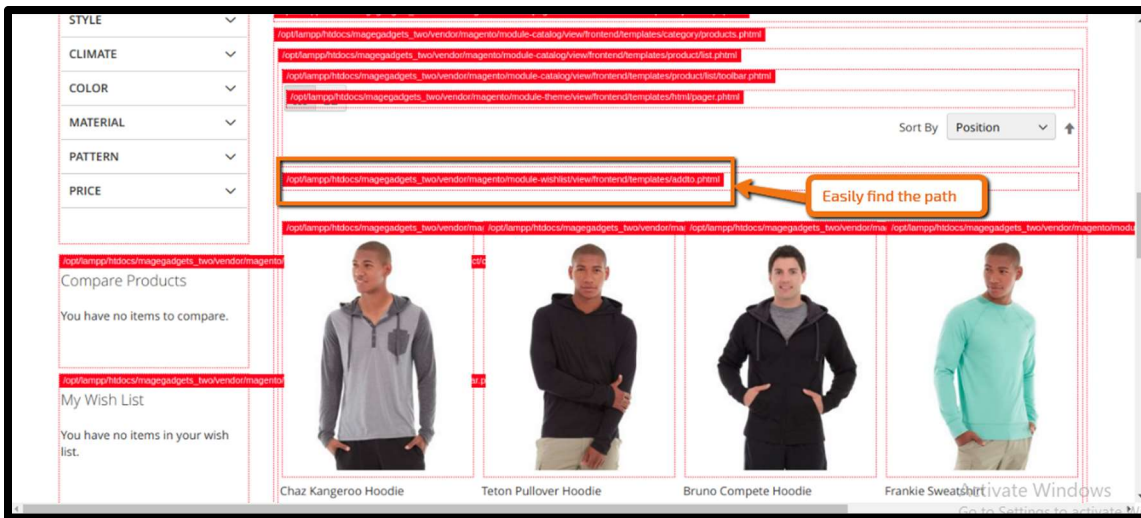

Thank you!

Should you have any questions or feature suggestions,

Please contact us at:

<http://www.magegadgets.com/contacts>

Your feedback is absolutely welcome!

